

Adventer Series

Walk-in Cooler

 -10% Energy Consumption

 Excellent Temperature Performance

 Highlight Display Effect

 Give Attention to Display and Storage



Product Features

- Compact air cooler especially designed for convenience stores and giving attention to display and storage;
- Unique design of 3-layer hollow anti fog glass door, for better visibility of merchandise for thermal insulation and energy saving;
- Integrated long-through door handles for convenient pickup;
- The opening directions of doors for replenishing goods are optional benefit for store layout;
- Adjustable leaning angles of shelves to satisfy different demands;
- Selectable gravity pulley for realizing automatic replenishment of beverages;
- Higher evaporating temperature, more energy-efficient and environmental friendly.

Adventer Series

Walk-in Cooler



Technical Data

Model	Dimensions/mm (L x W x H)	Operating Temperature /°C	Net Volume/m ³	Display Area/m ²
CWC4-22	3000*2200*2310	1 ~ 10	13	3
CWC4-20	3000*2000*2310	1 ~ 10	11.5	3
CWC4-18	3000*1800*2310	1 ~ 10	10	3
CWC4-16	3000*1600*2310	1 ~ 10	9	3
CWC3-22	2275*2200*2310	1 ~ 10	9.5	2.2
CWC3-20	2275*2000*2310	1 ~ 10	8.5	2.2
CWC3-18	2275*1800*2310	1 ~ 10	7.5	2.2
CWC3-16	2275*1600*2310	1 ~ 10	6.5	2.2
CWF1	875*900*2310	≤ -15	0.8	0.65

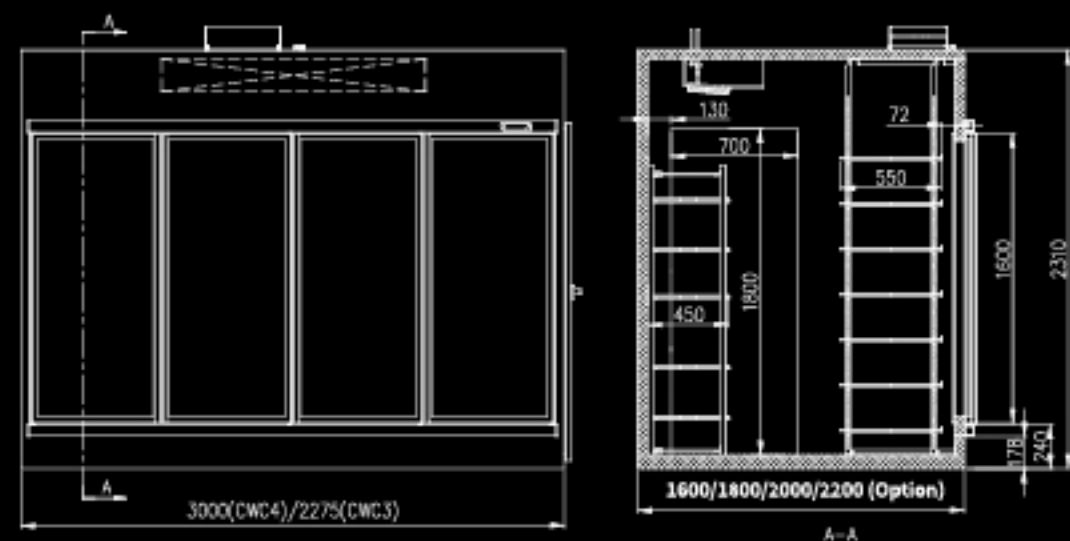

*All measured value based on Carrier cases and tests.